

Lightning Sprint Rear Axle Assembly

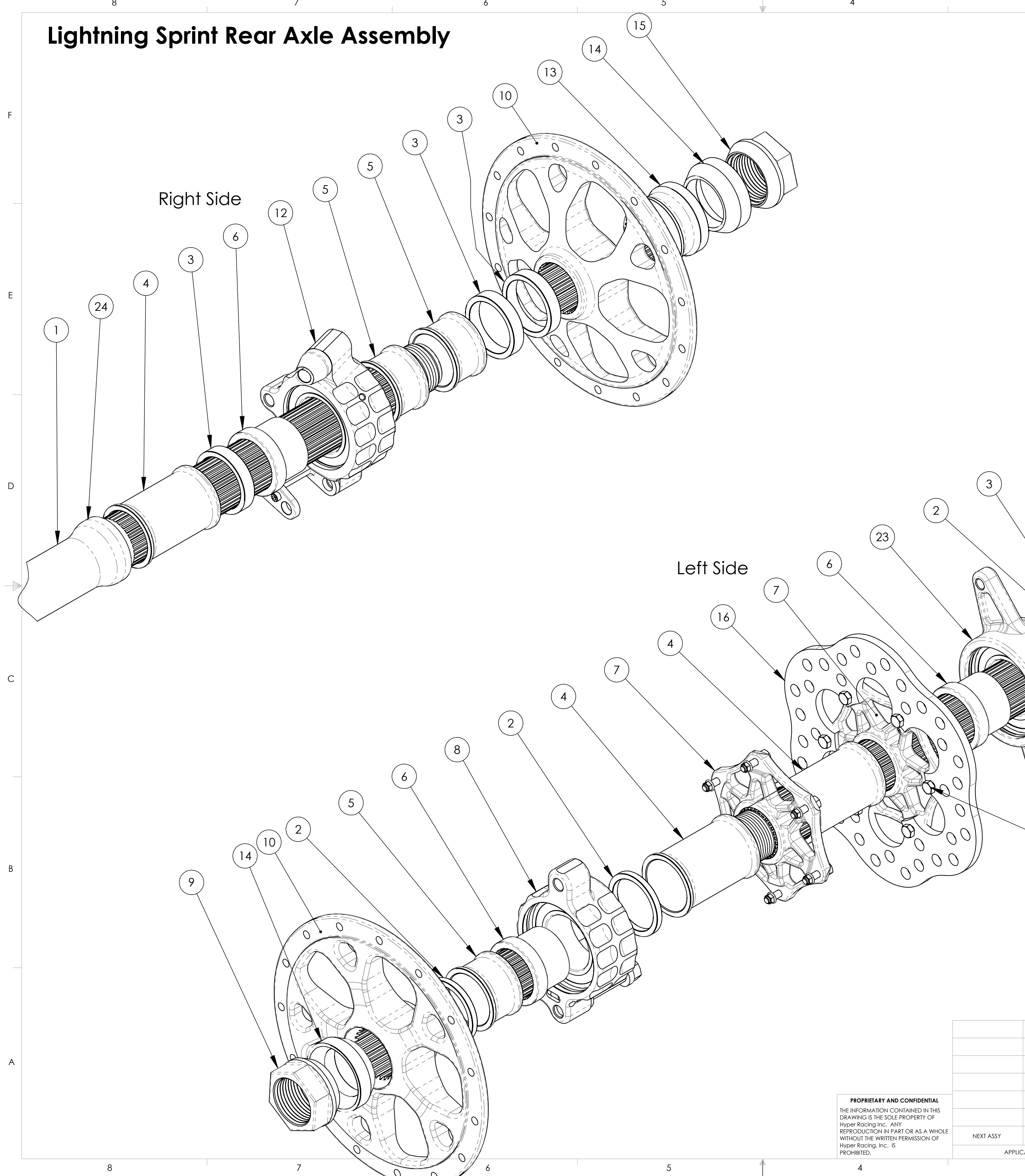

ITEM NO.	PART NUMBER	DESCRIPTION	QTY.
1	06-100	2" x 53" Standard Splined Rear Axle	1
2	061-025	1/4" Long 2" Axle Spacer	3
3	061-050	1/2" Long 2" Axle Spacer	4
4	061-350	3-1/2" long 2" Axle Spacer	3
5	061-150	1-1/2" long 2" Axle Spacer	3
6	06-114	2" Splined Bearing Reducer	3
7	06-300	2" Sprocket Carrier/Brake Hub	2
8	06-260	Left Rear Bearing Carrier for Lightning Sprint and Midget	1
9	06-132	2" Axle Nut, Right Hand Thread 2-1/4" Hex	1
10	257-300	2"x 13" Splined Rear Wheel Center	2
11	08-760	Sprocket Bolt Kit	1
12	06-250	Right Rear Bearing Carrier for Lightning Sprint and Midget	1
13	062-150	1-1/2" x 2" Outer Axle Spacer	1
14	062-050	062-050 1/2"	2
15	06-134	2" Axle Nut, Left Hand Thread 2-1/4" Hex	1
16	046-142	Lightweight Steel Brake Rotor 10" x 1/4"	1
17	06-143	6 Bolt Brake Rotor Bolt Kit	1
23	06-290	2" Axle Brake Floater Double Wide	1

PROPRIETARY AND CONFIDENTIAL
 THE INFORMATION CONTAINED IN THIS DRAWING IS THE SOLE PROPERTY OF Hyper Racing Inc. ANY REPRODUCTION IN PART OR AS A WHOLE WITHOUT THE WRITTEN PERMISSION OF Hyper Racing, Inc. IS PROHIBITED.

UNLESS OTHERWISE SPECIFIED:		NAME	DATE
DIMENSIONS ARE IN INCHES		Mike	2/23/2016
TOLERANCES:		DRAWN	
FRACTIONAL ± 1/64		CHECKED	
ANGULAR: MACH ± .01 BEND ± 1		ENG APPR.	
TWO PLACE DECIMAL ± .010		MFG APPR.	
THREE PLACE DECIMAL ± .005		Q.A.	
INTERPRET GEOMETRIC TOLERANCING PER:		COMMENTS:	
MATERIAL			
FINISH			
NEXT ASSY	USED ON		
APPLICATION	DO NOT SCALE DRAWING		

Hyper Racing Inc.
 580 Grandview Drive
 Lewisberry, PA 17339

TITLE:
 2013 & Up Lightning Sprint Rear Axle Assembly

SIZE DWG. NO. REV
C Lightning Sprint 06-050

SCALE: 1:8 WEIGHT: SHEET 1 OF 1